

# Building Height Definitions

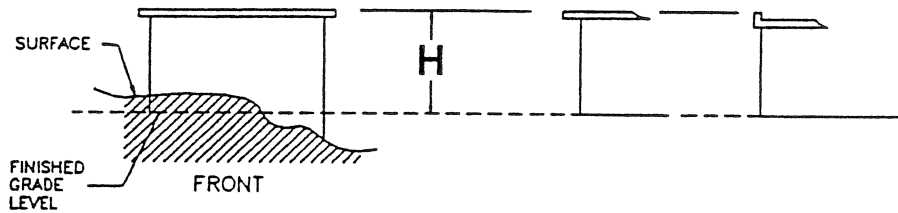

FLAT ROOF

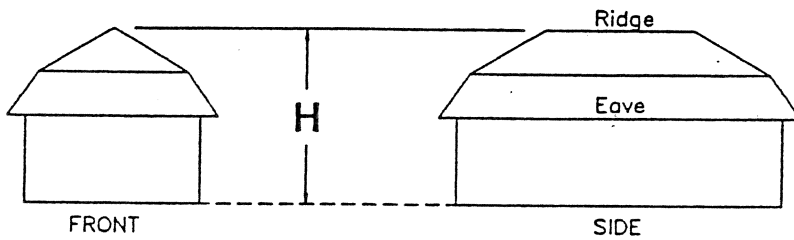

MANSARD ROOF

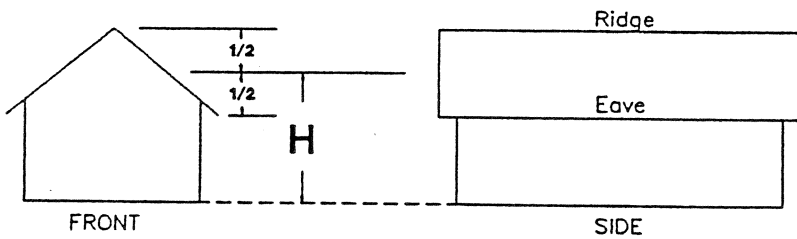

GABLE ROOF

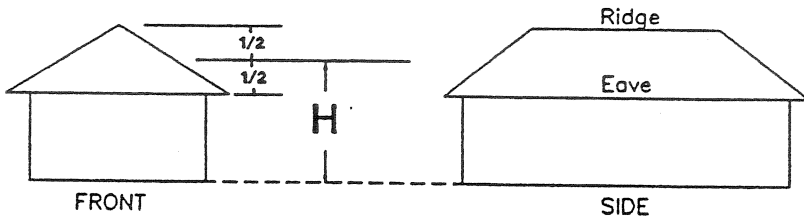

HIP ROOF

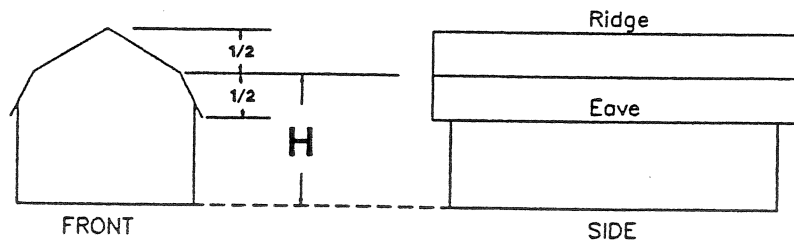

GAMBREL ROOF

H - HEIGHT OF BUILDING

# Lot Frontage

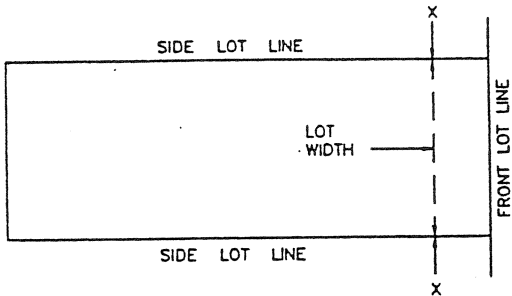

(A) SIDE LOT LINES ARE PARALLEL;  
STREET IS STRAIGHT

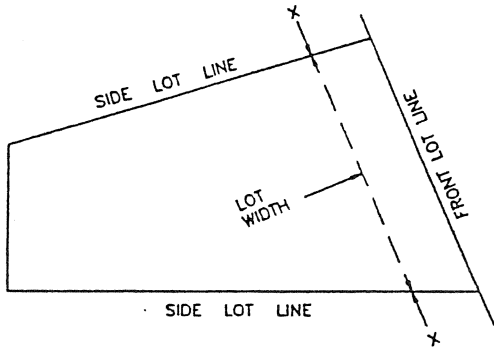

(B) FRONT AND REAR LOT LINES  
ARE NOT PARALLEL

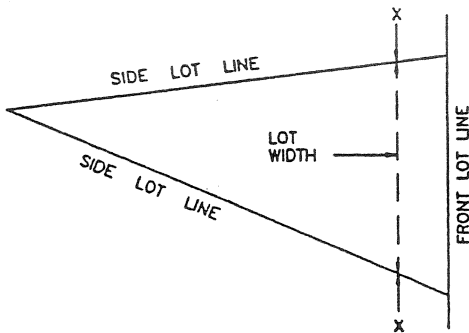

(C) NO REAR LOT LINE

## LEGEND

$d$  = DISTANCE BETWEEN FRONT LOT LINE AND  
INTERSECTION OF MINIMUM FRONT YARD WITH  
INTERIOR SIDE LOT LINE

$X$  = POINT OF INTERSECTION OF MINIMUM FRONT YARD  
WITH INTERIOR SIDE LOT LINE(S)

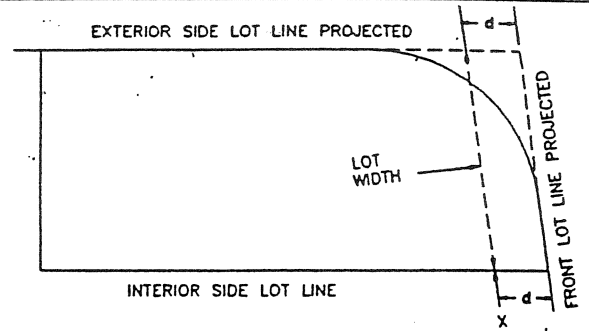

(D) CORNER LOT WITH A CURVE

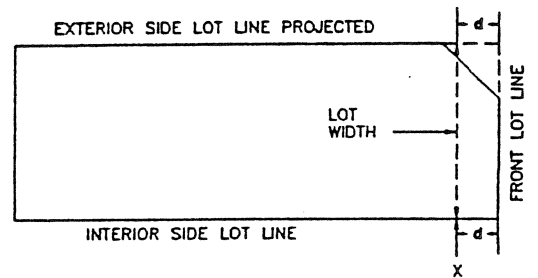

(E) CORNER LOT WITH A DAYLIGHT  
TRIANGLE

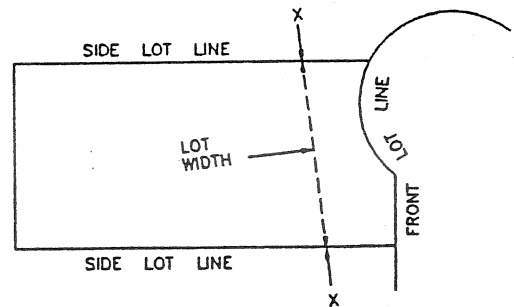

(F) LOT ON A CORNER EYEBROW

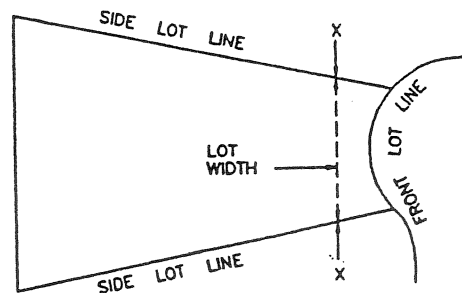

(G) LOT ON A CUL-DE-SAC

# Yard Definitions

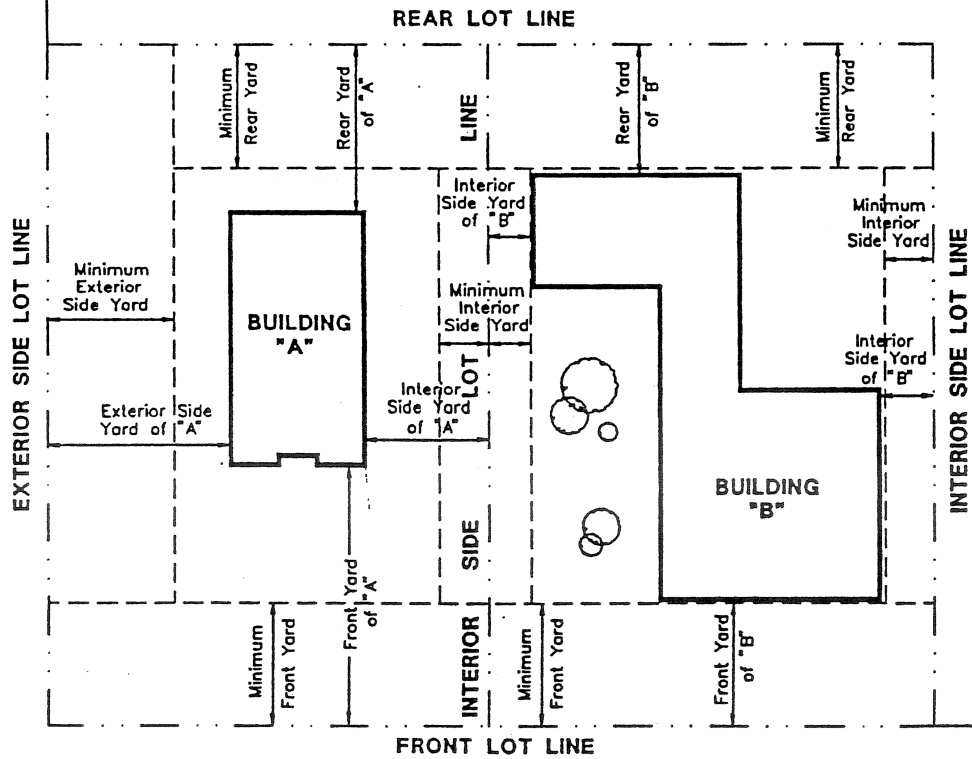

# Dwelling Unit Types

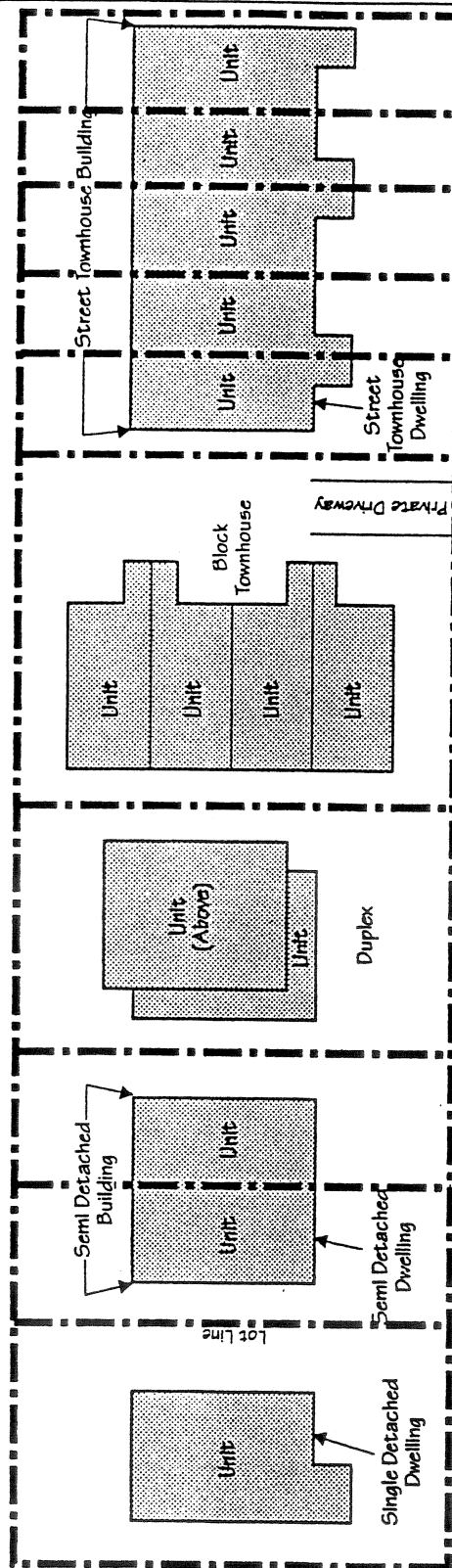

IMPROVED STREET

--- Lot Line

# Dwelling Unit Types (continued)

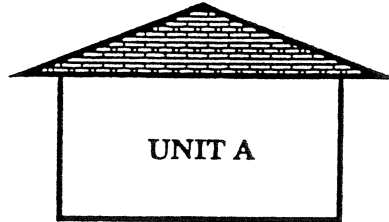

**SINGLE DETACHED DWELLING**

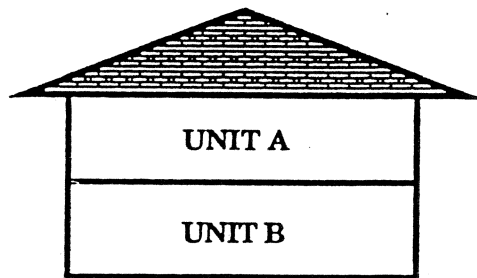

**DUPLEX DWELLINGS**

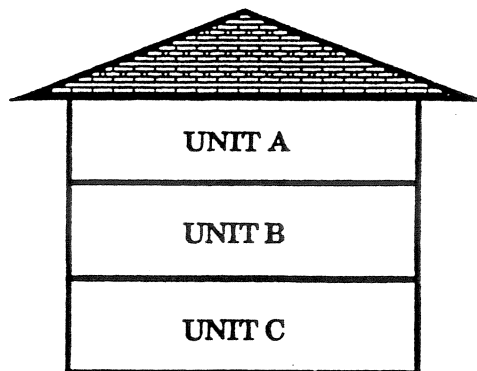

**TRIPLEX DWELLINGS**

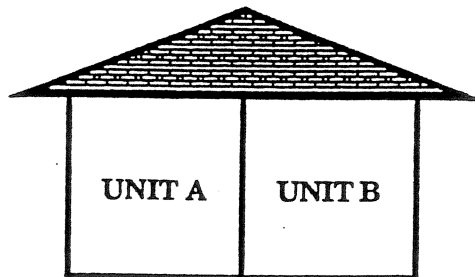

**SEMI-DETACHED DWELLINGS**

# Dwelling Unit Types (continued)

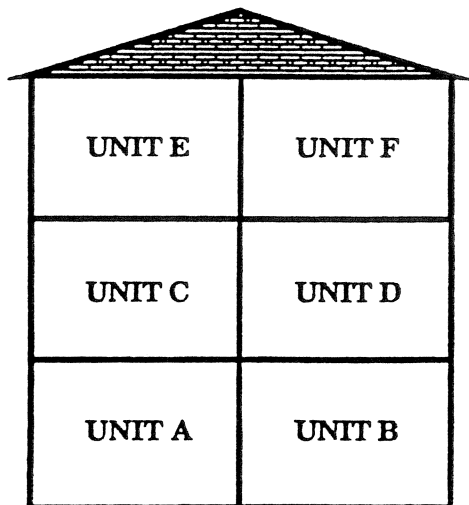

APARTMENT DWELLINGS

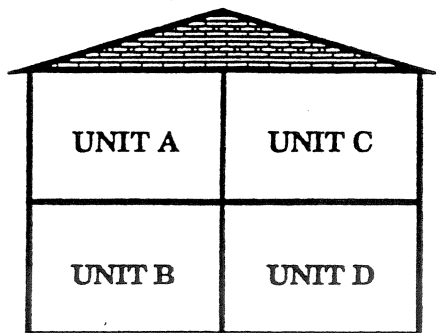

FOURPLEX DWELLINGS

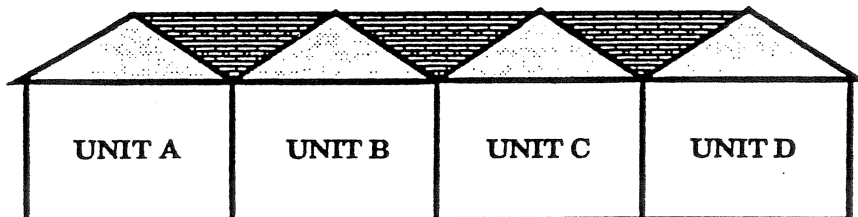

TOWNHOUSE DWELLINGS

# Cellar, Basement and Storey

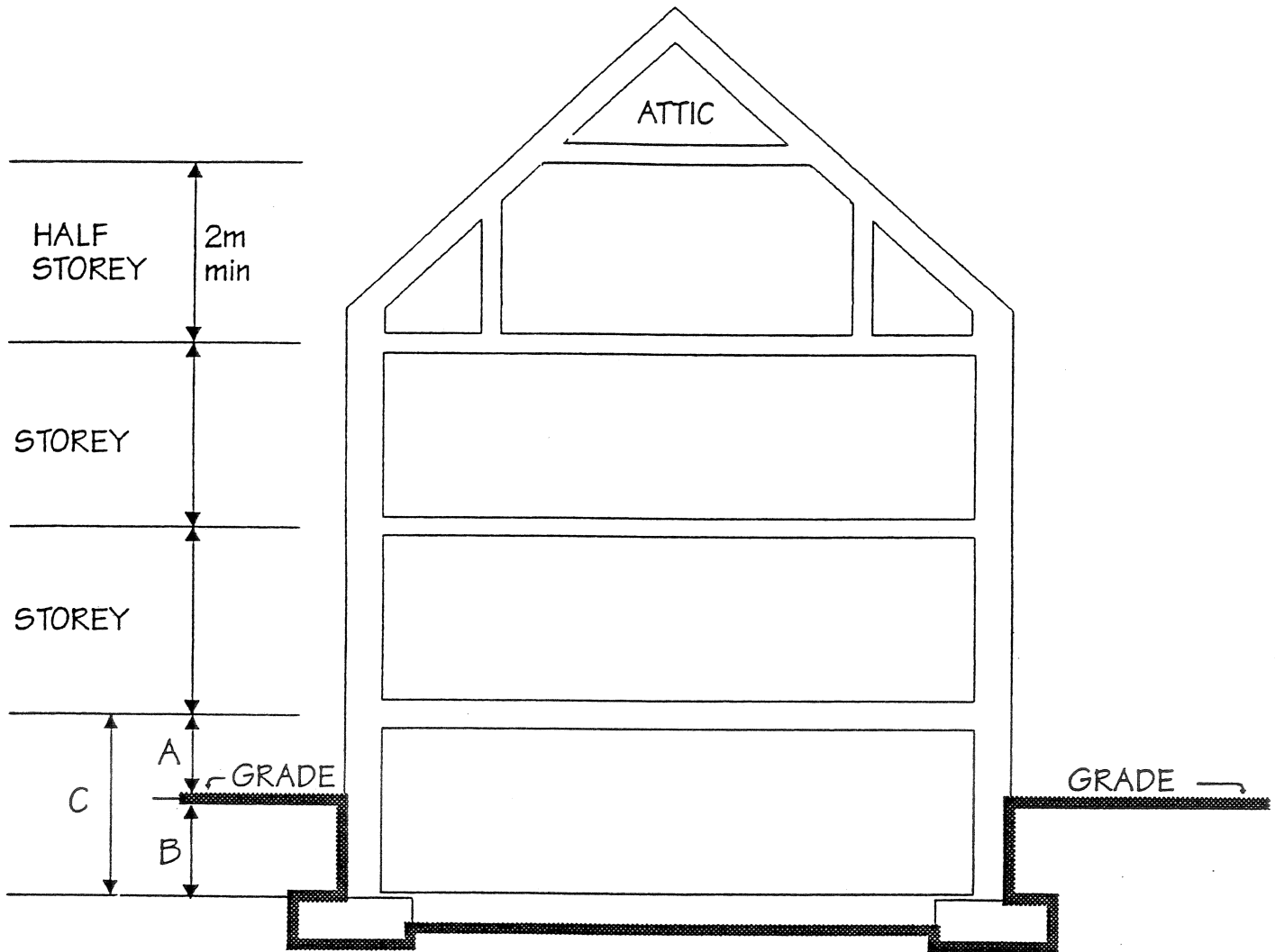

When 'A' is less than 'B', 'C' is a cellar

When 'A' is greater than or equal to 'B', 'C' is a basement

'Grade' for the purpose of this illustration, means the average level of the finished ground adjoining a building or structure at all exterior walls

# Lot Definitions

