

BERNARDI PRECAST PIT

PART SW 1/2 LOT 3, CONCESSION 4
TOWNSHIP OF GUELPH-ERAMOSA
(FORMER TOWNSHIP OF ERAMOSA)
COUNTY OF WELLINGTON

Page 4 of 4 CROSS SECTIONS

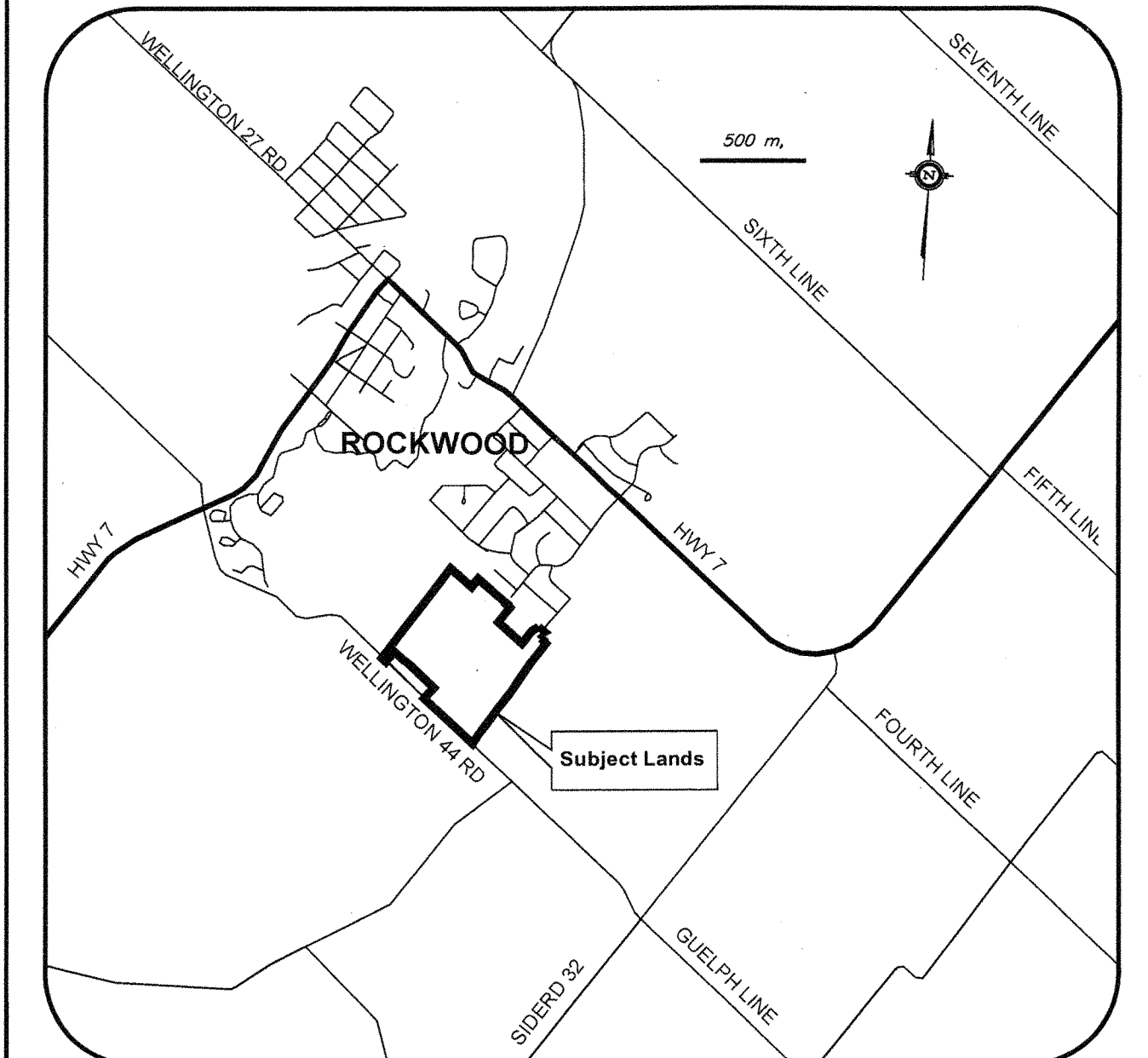
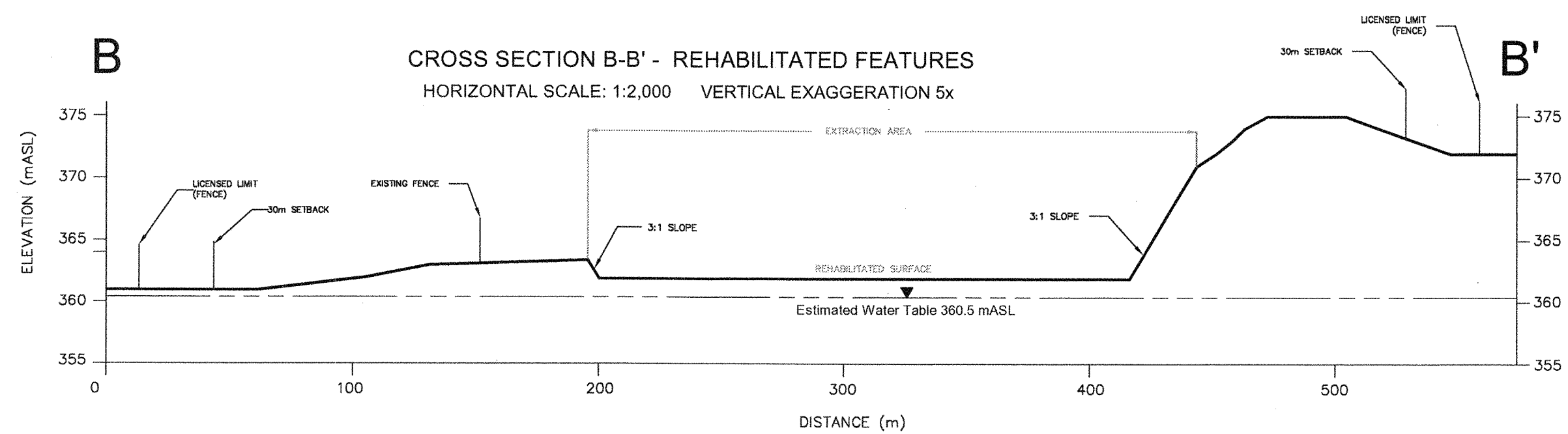
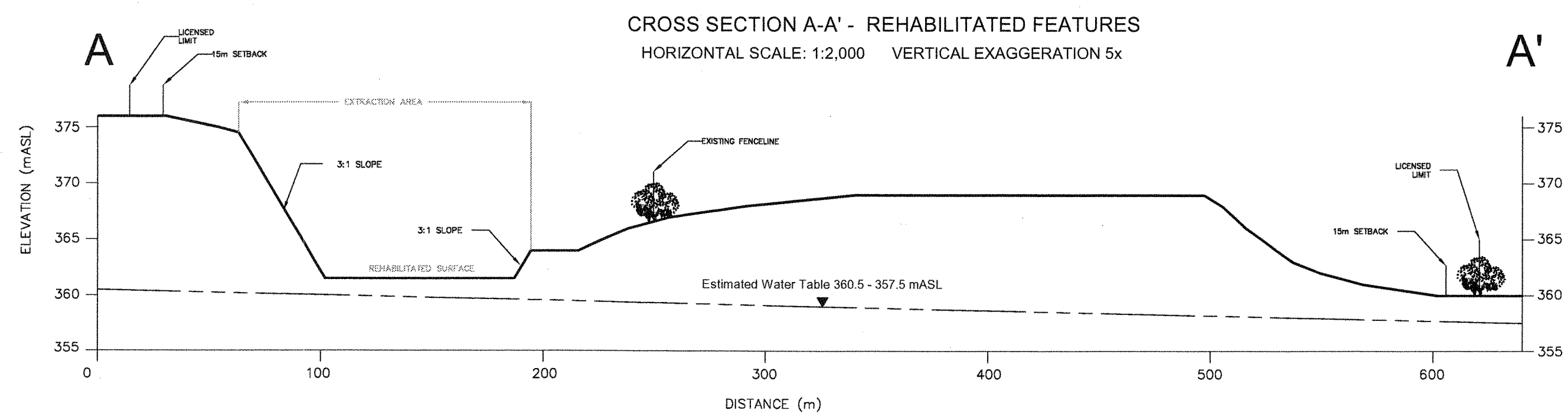
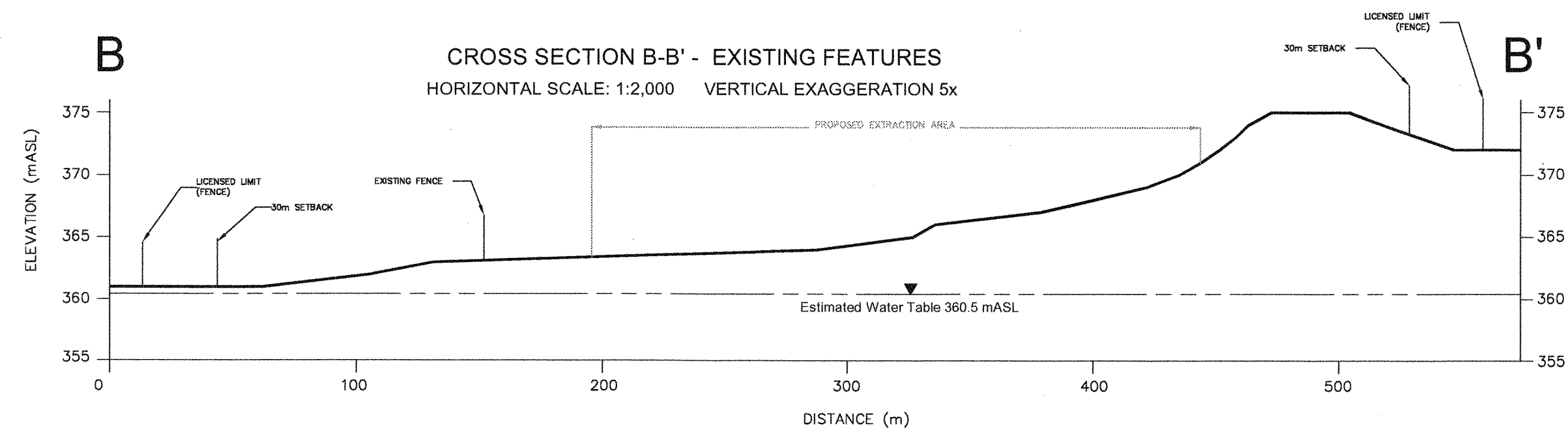
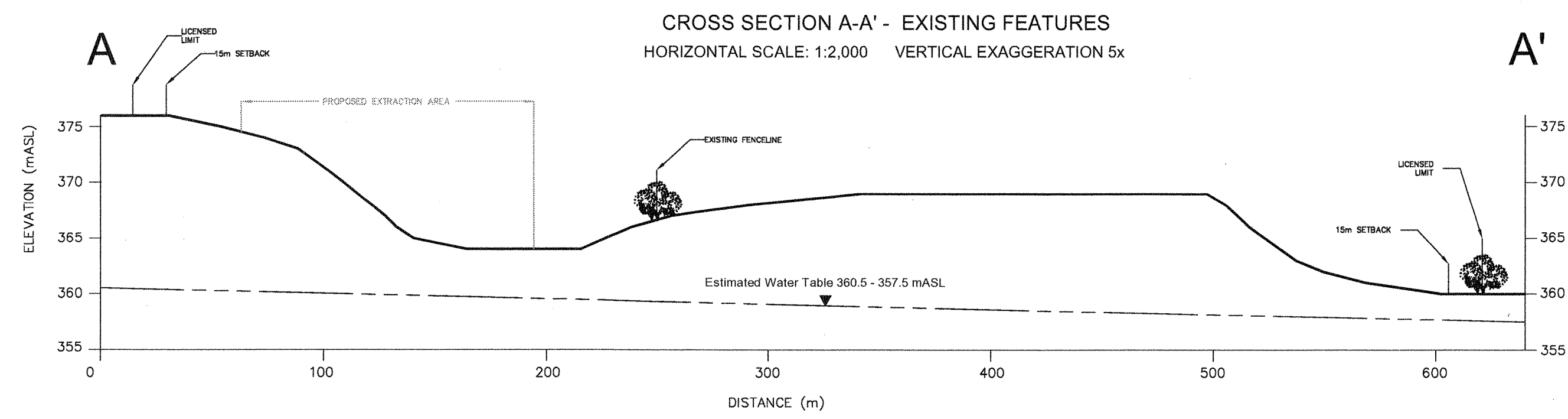

THIS PLAN IS PREPARED UNDER THE AGGREGATE RESOURCES ACT FOR A CLASS A LICENCE, CATEGORY 3.

THESE SITE PLANS HAVE BEEN PREPARED UNDER THE DIRECTION OF AND CERTIFIED BY A PERSON APPROVED BY THE MINISTER OF NATURAL RESOURCES (AS PER SECTION 8(4) OF THE AGGREGATE RESOURCES ACT).

SIGNATURE: _____ DATE: _____

1253252 ONTARIO LIMITED
412 Elizabeth Street
Guelph, Ontario N1E 2Y1

FILE: H:\BOB_GIBSON\8572 - GIBSON - Bernardi Precast\cad\berardi precast pit.dwg

REVISED: Sep 06, 2013 APPROVED: R.J.G CHECKED: R.J.G

No.	DATE	DESCRIPTION	APP'D
AMENDMENTS			

ROBERT GIBSON CONSULTING SERVICES INC.
15 IDLEWOOD DRIVE KITCHENER, ONTARIO N2A 1H9
PHONE (519) 894-0273 FAX (519) 894-9526